

# PERSÖNLICHE KONFIGURATION

erstellt am 20.11.2025



PLANUNGSDOKUMENT

Angebot 000558

## Sortimo Individualkonfiguration

Frontantrieb/Heckantrieb/Allradantrieb | | Heckklappe/Flügeltür | mm



**Sortimo®**

# PERSÖNLICHE KONFIGURATION

erstellt am 20.11.2025

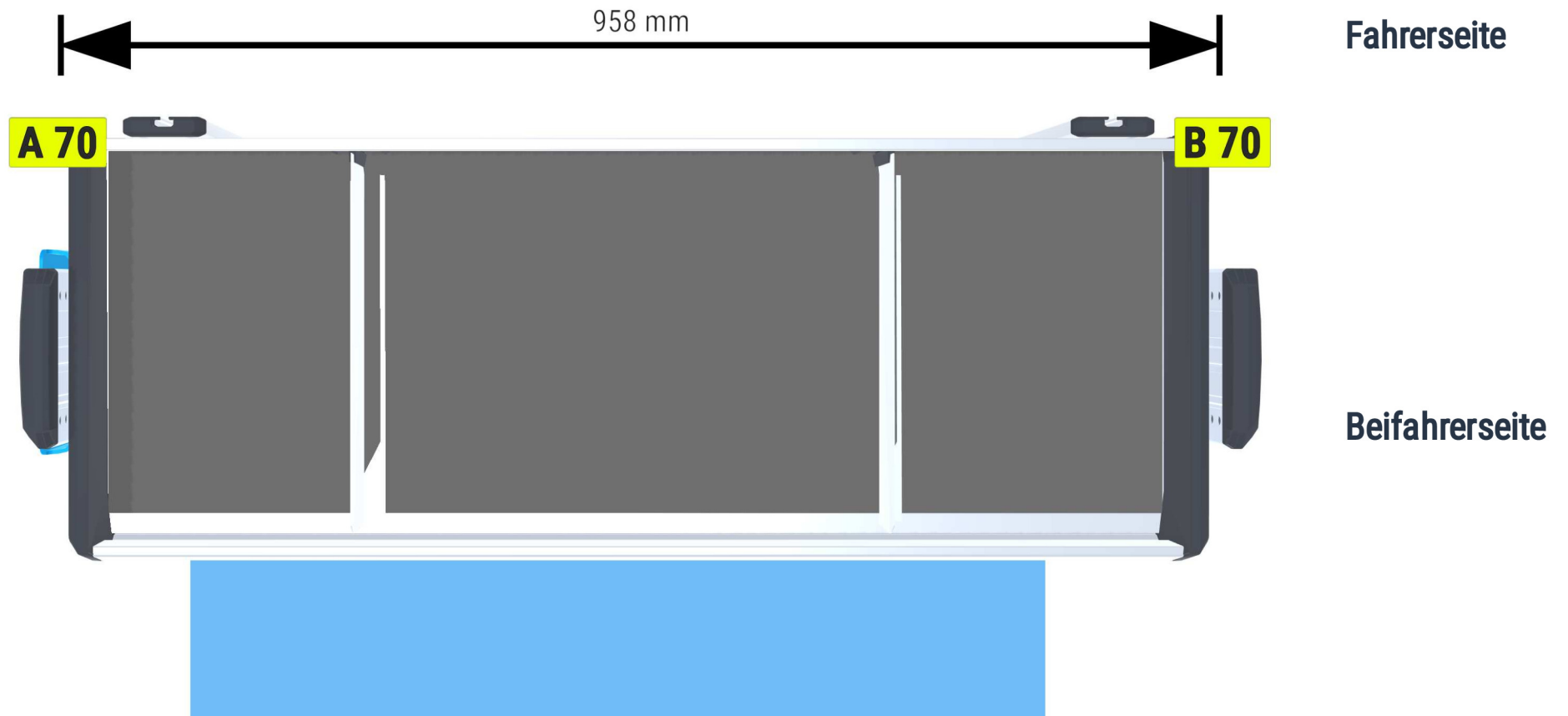

# PERSÖNLICHE KONFIGURATION

erstellt am 20.11.2025



# PERSÖNLICHE KONFIGURATION

erstellt am 20.11.2025

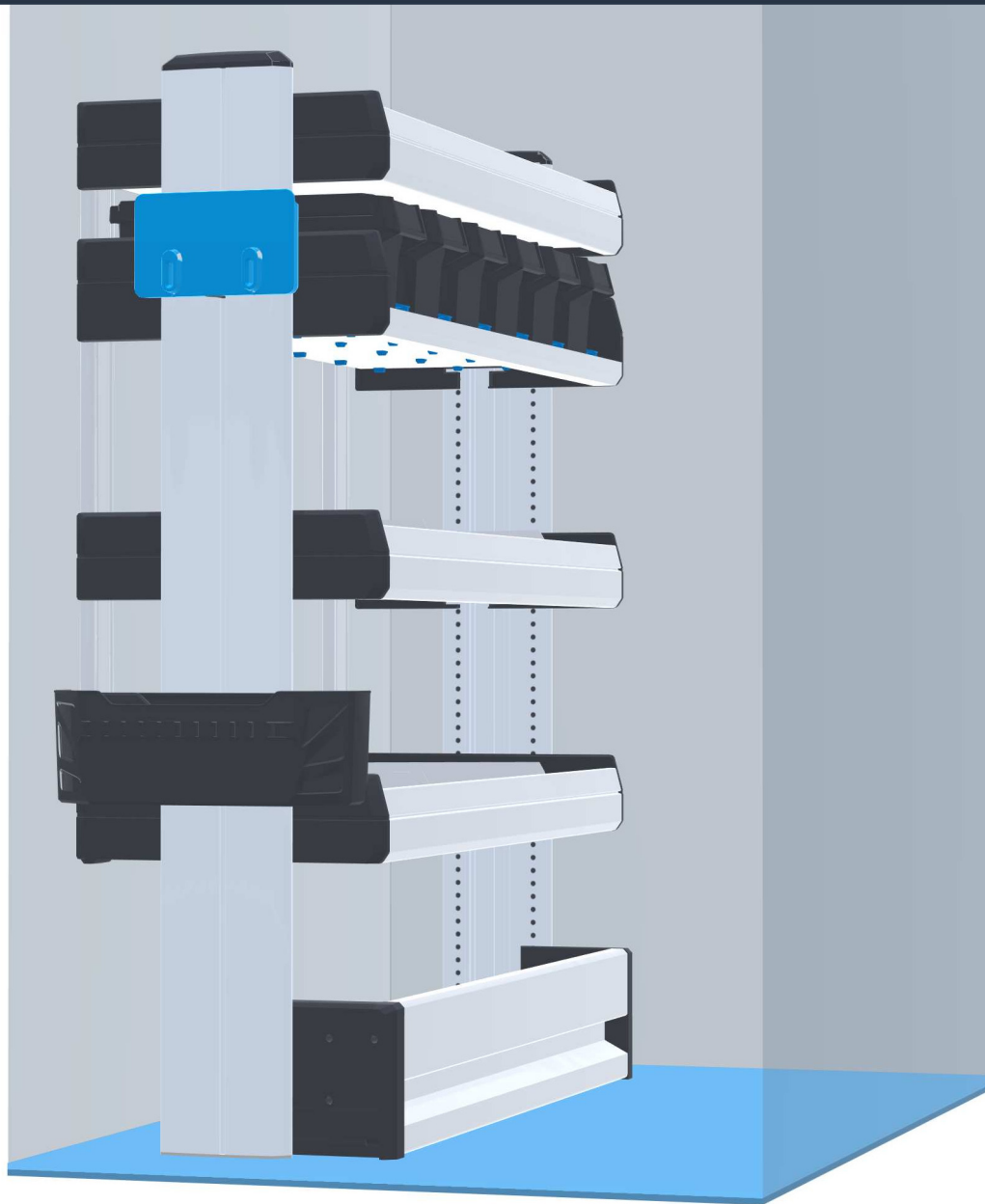

# PERSÖNLICHE KONFIGURATION

erstellt am 20.11.2025

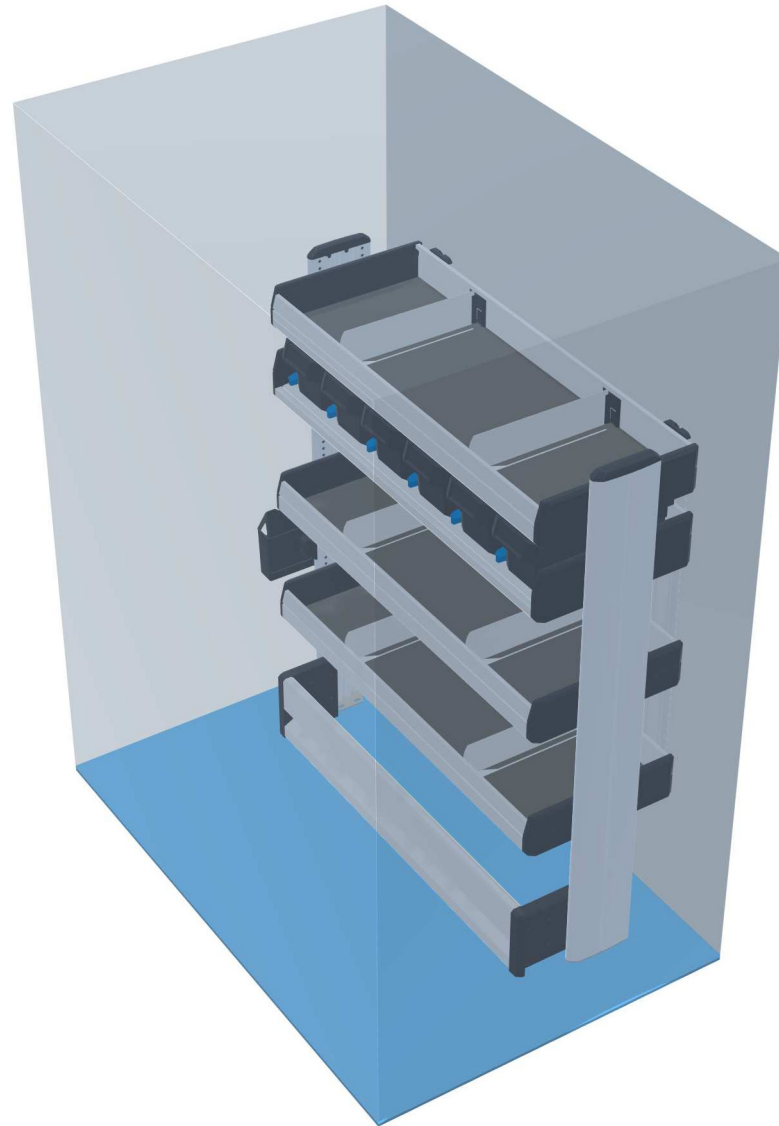



# PERSÖNLICHE KONFIGURATION

erstellt am 20.11.2025

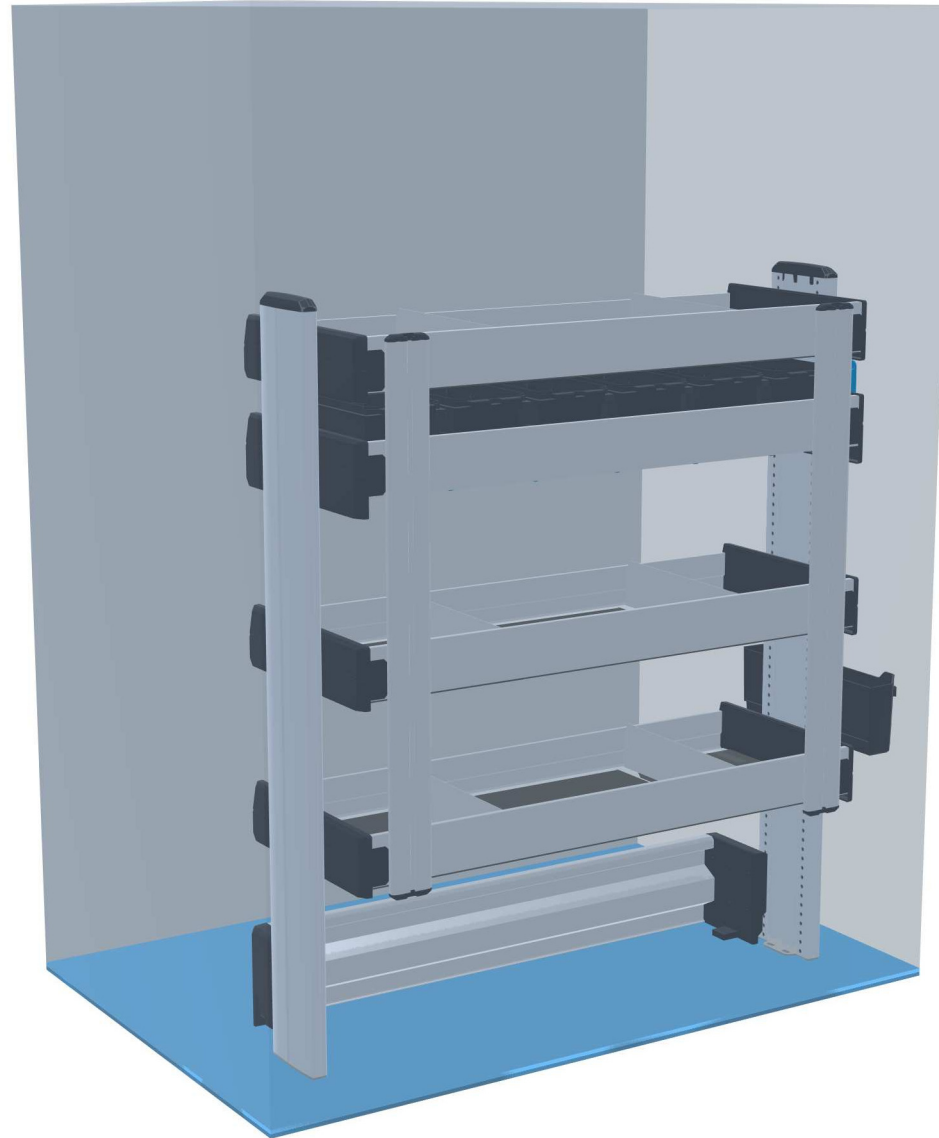



[Produkte](#) | [Support](#) | [Unternehmen](#) | [Kontakt](#) | [Blog](#)

Sortimo vor Ort



Anmelden



Warenkorb





**Sortimo®**  
STATION ESSEN

**Angebot 000558**

Startseite > Konfigurator





Eco



  
1  
Laderaum

  
2  
Konfiguration

  
3  
Zubehör

  
4  
Übersicht





**Sortimo Station Essen**  
**Johanniskirchstr. 98**  
**45329 Essen**

**Telefon: +49 (0) 201 - 747 00 81**

**service@sortimo-essen.de**

**[www.sortimo-essen.de](http://www.sortimo-essen.de)**